

ASF2 Cart Assembly Instructions

Step 1: Ensure that all assembly parts A-F, are all accounted for out of the box.

***NOTE:** Parts A, B, and C will be assembled together and will become Qty 2 35" long posts (AC) and Qty 2 30" short posts (BC).

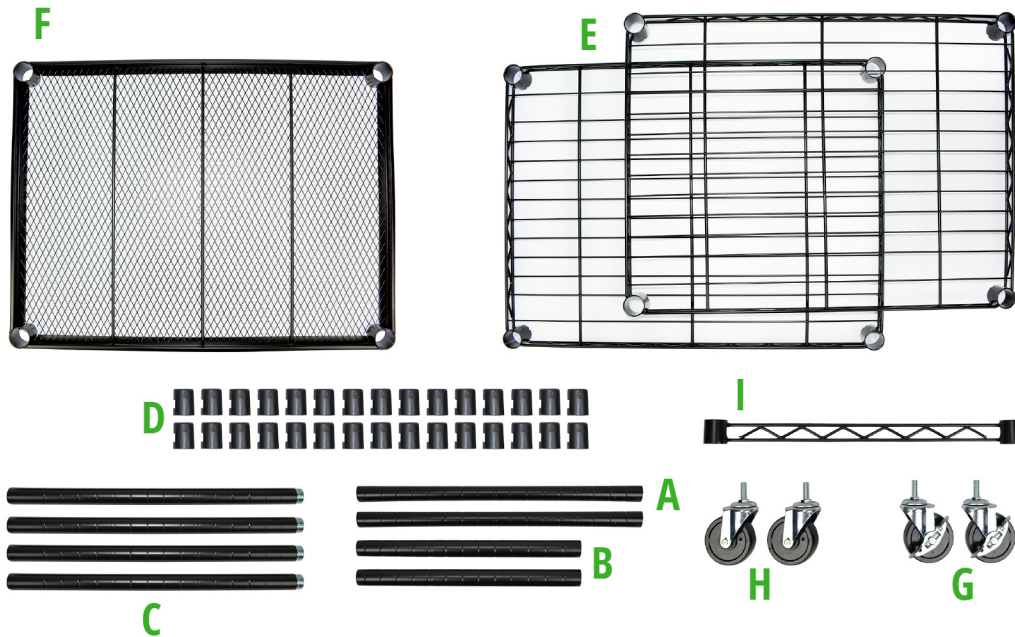

- Parts A:** 18" Top posts (2)
- Parts B:** 13" Top posts (2)
- Parts C:** 17" Bottom posts (4)
- Part D:** Support Brackets (30 pieces/15 pairs)
- Part E:** Film Shelves (2)
- Part F:** AirSaver Unit Shelf (1)
- Part G:** Brake Wheels (2)
- Part H:** Standard Wheels (2)
- Part I:** Sidebar (1)

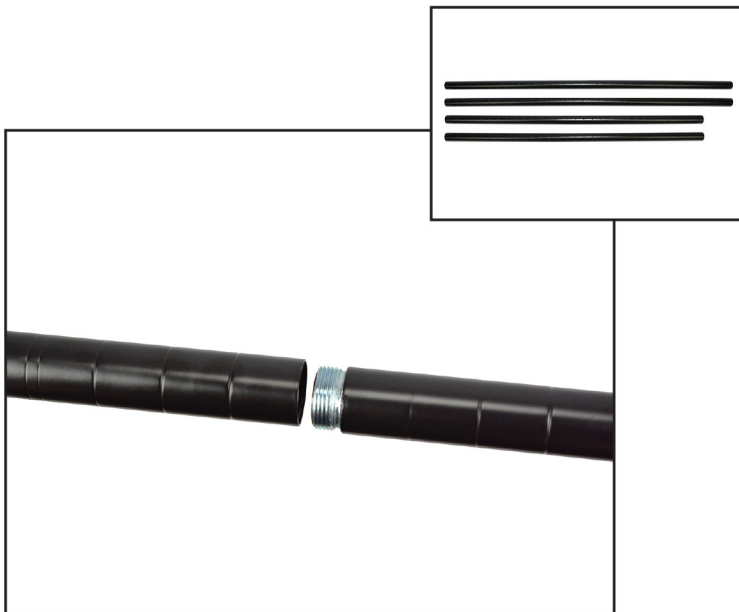

Step 2: Combine parts A with C to create Qty 2 35" Posts (AC) and Parts B with C to create Qty 2 30" Posts (BC).

***NOTE:** Parts G and H (Brake wheels & Standard Wheels) will only screw into Bottom Posts (C).



Step 3: Take 8 Support Brackets (D), and clip them onto the bottom of the Post pieces (AC & BC). Use the engraved lines on each Bottom post as a guide to ensure the brackets are equally aligned.

***NOTE:** Using the bottom two lines of the C Posts to support the bottom shelf is recommended.

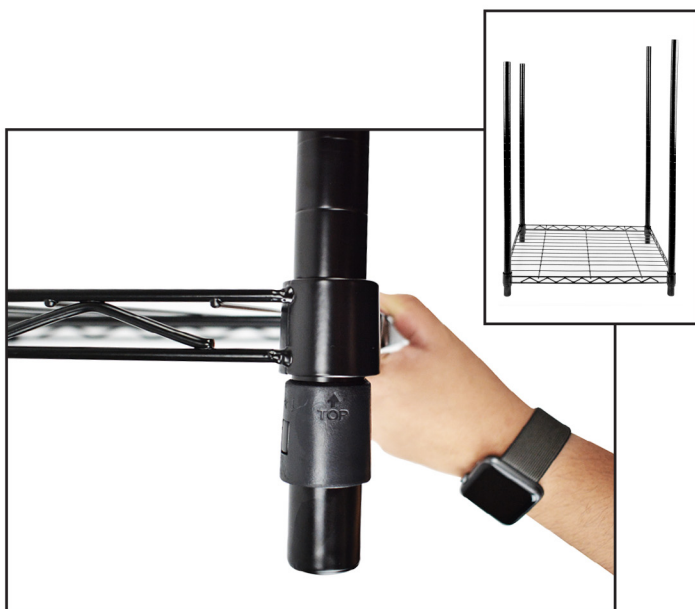

Step 4: Take one of the film shelves (E) and place the 4 Posts (AC & BC) into the designated post-holes until the shelf locks into place by the support brackets.

***NOTE:** Place the Longer Posts (AC) closest together at one end of the shelf, with Shorter Posts (BC) closest together on the other end of the shelf. Hold Support Brackets (D) in place while inserting the shelf to ensure they do not slide out of position.

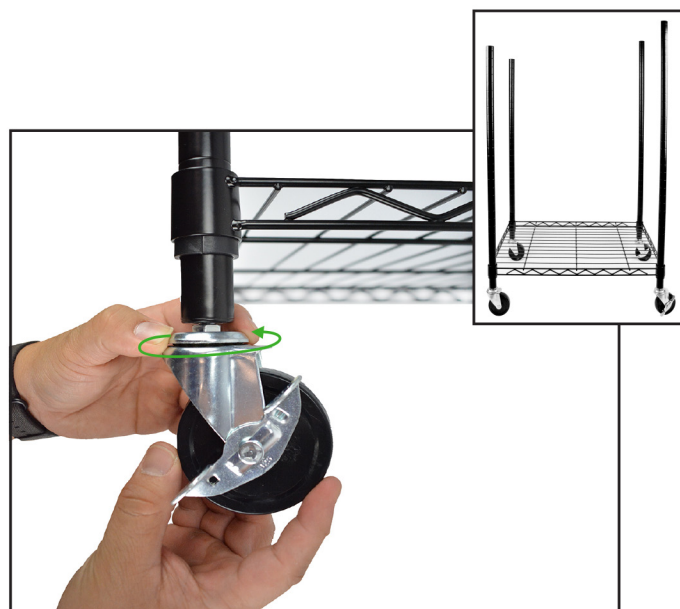

Step 5: Take the Brake Wheels (G) and hand-screw them onto the Posts (AC). Take the Standard Wheels (H) and hand-screw them onto Posts (BC).

***NOTE:** Hold the bottom portion of the wheel and twist only the top section to screw them into the post.



Step 6: Take 8 more Support Brackets (D), and clip them onto the middle of each Post (AC & BC). Use the two closely spaced lines as a guide to ensure that the brackets are evenly placed.

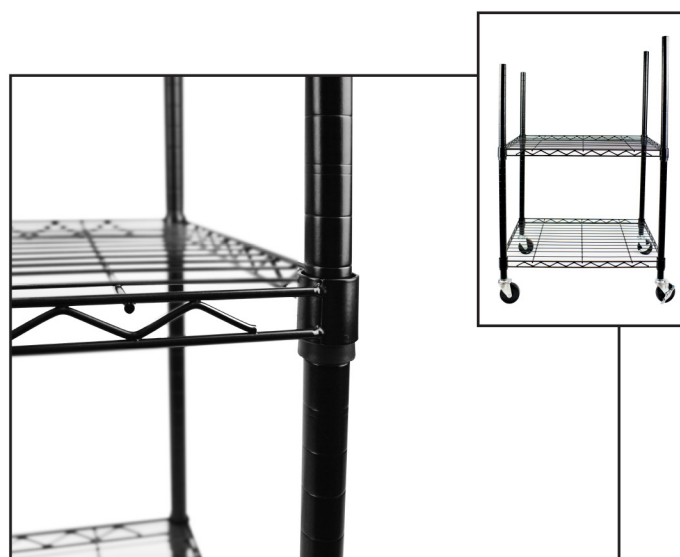

Step 7: Take the last film shelf (E) and place the 4 Posts (AC & BC) into the designated post-holes until the shelf locks into place by the support brackets installed on the previous step.

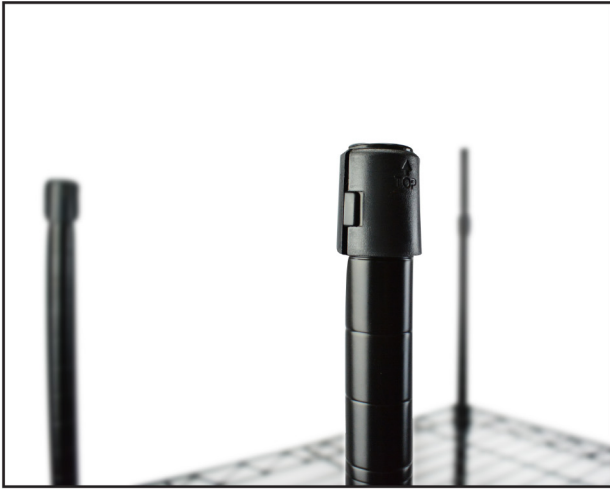

Step 8: Take 4 Support Brackets (D) and clip them onto the very top of the Short Posts (BC), using the two closely spaced lines as a guide. Use 4 more Support Brackets (D) to clip onto the upper-most closely spaced lines of the Long Posts (AC).



Step 9: Take the AirSaver Shelf (F) and place it through all 4 posts (AC & BC). Use the Support Brackets (D) placed in the previous step to secure the shelf into place.



Step 10: Take the last 4 Support Brackets (D) and place them onto the very top of the Long Posts (AC). Take the Sidebar (I) and place it through the Long Posts (AC). Secure the Sidebar (I) using the Support Brackets (D) placed on the Long Posts (AC).

