

## ASFX Winder Installation Steps

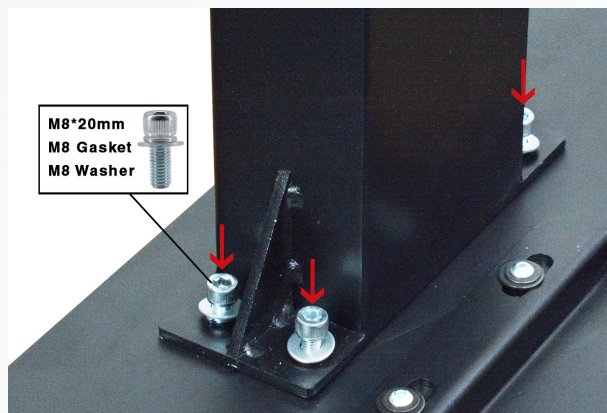

### Step 1:

Align the support bar with the four holes on the support base. Winder screen and motor should be facing towards bottom square. Use screws M8\*20mm, gaskets, and washers to secure the column to the base. Reference picture for orientation.



### Step 2:

Align the four holes on the installation table on the support bar and secure using screws M8\*20mm, gaskets, and washers.



### Step 3:

Secure the roller module to the installation table using two M8\*35mm screws and one M8\*20mm screw, reference the picture for correct screw placement. All screws will use M8\* gaskets and washers.



### Step 4:

Using the two M8\*35mm screws, secure the film leading bar module to the installation table. **Note:** Adjust the bar to be angled 3cm towards the machine, reference picture for details.

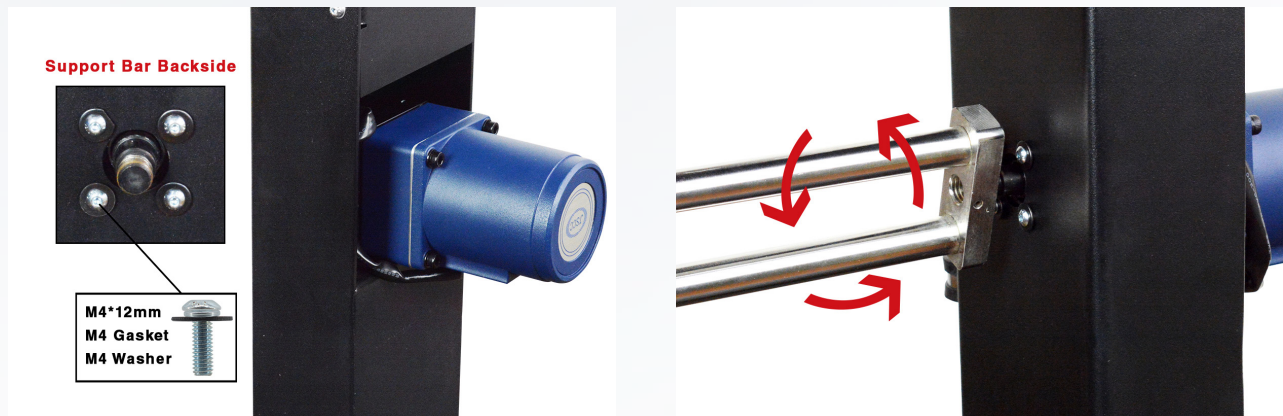

### Step 5:

Install the winder motor to the support bar using four M4\*12mm screws, gaskets, and washers. Attach the winder rods to motor by rotating counterclockwise. Turn until hand tight.



### Step 6:

Remove the four M4\*12mm screws to take off the back cover of the support bar. Place motor wires through the double-sided protective ring. Connect the three wires according to the corresponding terminals U1, U2, Z2 by loosening and tightening the screws, once connected secure the back cover back on the support bar.



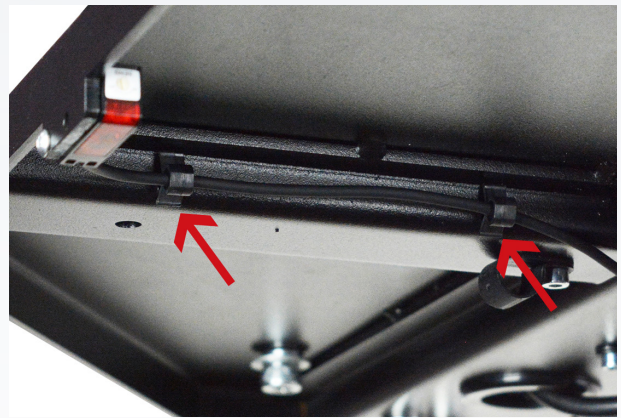
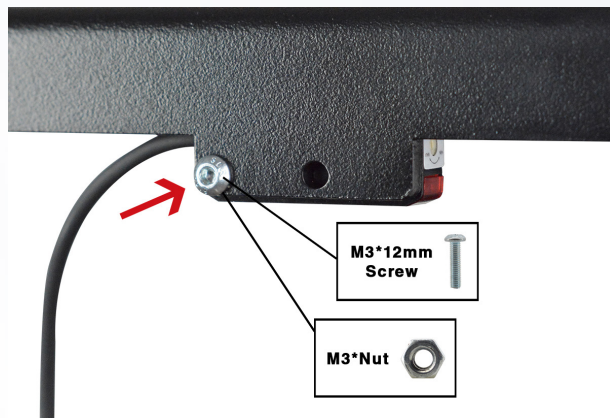

### Step 7:

Secure the sensor to the installation table using M3\*12mm screw and nut. Sensor wire will be secured using the rubber clamps under the installation table.



### Step 8:

Remaining two wires will be inserted through the double-sided protective ring. The M4\* screws connected to the installation table will be unscrewed and screwed back on once wires are inserted into the double-sided protective ring.

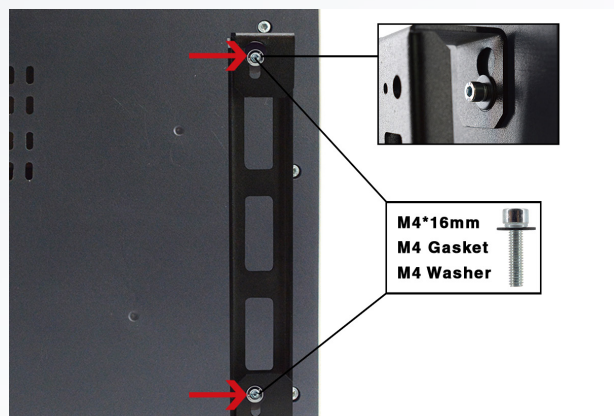
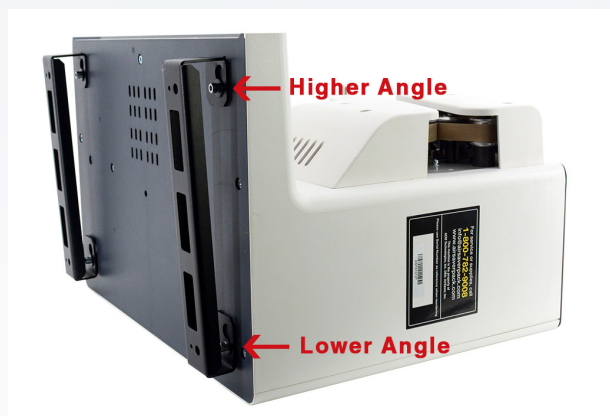

### Step 9:

Connect the feet to the bottom of the ASFX machine using four M4\*16mm screws, gaskets, and washers. **Note:** Higher angle goes towards the film side machine in the locked in position.

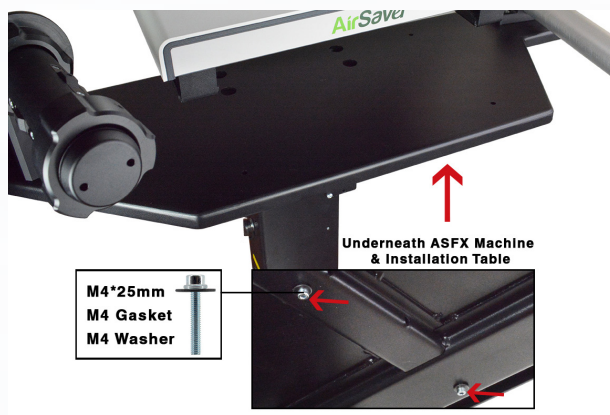

### Step 10:

Secure the ASFX to the installation table using four M4\*25mm screws, gaskets, and washers aligning from underneath the plate. Reference picture for example.



### Step 11:

Load film onto film roller with arrows facing towards the machine. Film will go under film align rod and in-between double rods.



### Step 12:

On the side of the film that is closest to the machine, create a small opening and thread film through the feeding tube up to the belts.



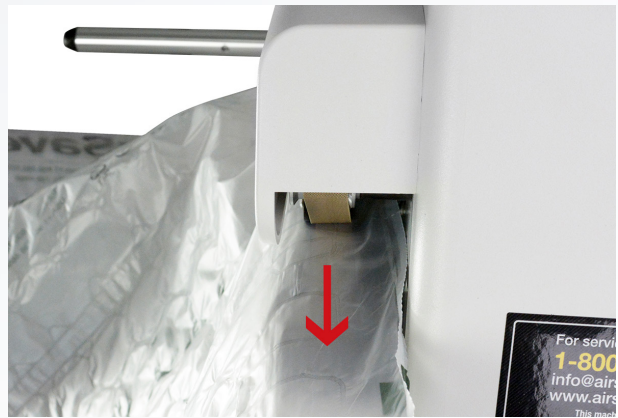
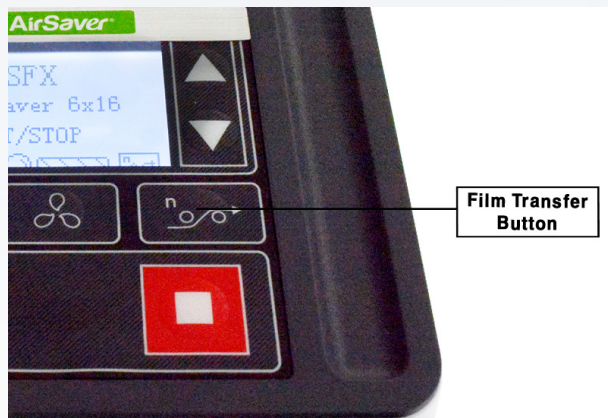

### Step 13:

On the machine press the  button and help guide the film to the front of the machine. This will ensure that the film is fed properly when the machine begins to produce pillows.



### Step 14:

Hit play, film will go over the film leading bar module.



**Step 15:**

Hit stop. Once stopped, align the film to go in-between the fork rods.



**Step 16:**

Hit the green button on the support base to activate winder. Hit play on the machine to start creating air pillows.





**Step 17:**

Machine should be creating air pillows and winder should be spinning.