

SETUP & INSTALLATION MANUAL FOR ASFX MACHINE

New
Display & Setting
Functions

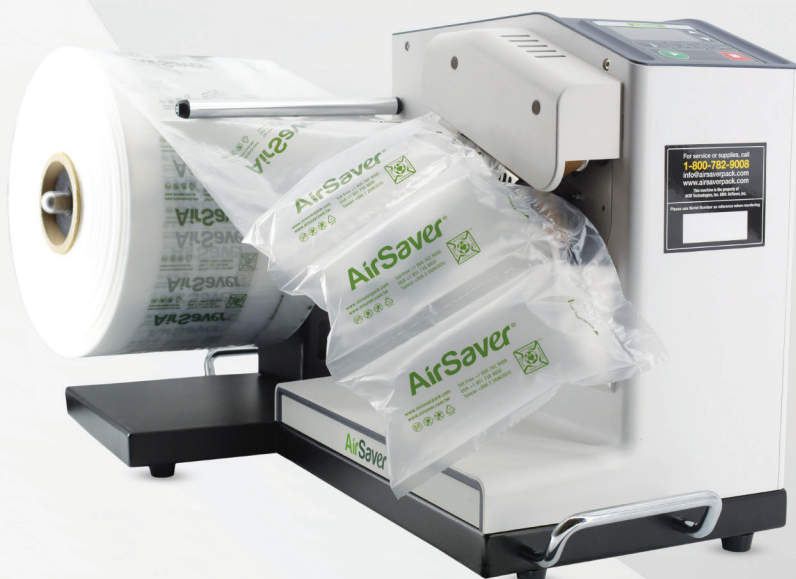

Weight: 19.36 lbs.

Electrical: AC100-120v, 380w

Speed: 35 linear feet per minute

AirSaver®

Contents

SAFETY.....	1
1. ASSEMBLY.....	2
2. CONTROL PANEL OPERATIONS.....	3
2.2 Main Interface.....	3
3. PARAMETER LOCK.....	3
4. OPERATING GUIDE.....	4
5.TROUBLESHOOTING.....	5
6. PARTS REPLACEMENT METHOD.....	6
6.1 Belt Replacement Instructions.....	6
6.2 Blade Replacement Instructions.....	7
6.3 Heating Block Replacement Instructions.....	9

Safety

- Always use the supplied power cable that is provided with the machine.
- During installation set up the machine should be off with the power cable disconnected.
- Before replacing any parts, the machine should be cooled off, and powered off.
- Upon any of the situations listed below, the machine should be powered off and an AirSaver Technician called:
 - o Any abnormal noise coming from the machine
 - o Any burning smells from the machine
- Machine should be powered off at the end of the day.

1. Assembly

ASFX FILM ROLLER ASSEMBLY

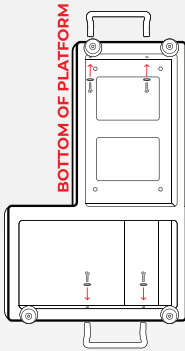

1. **INSTALL THE HANDLES ON BOTH SIDES OF THE PLATFORM USING THE APPROPRIATE ALLEN WRENCH AND SCREWS WITH WASHERS.**

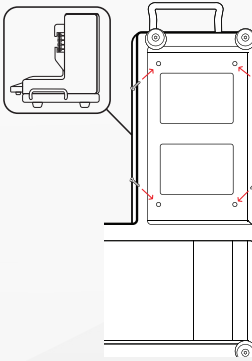

2. **PLACE THE PLATFORM AND MACHINE ON ITS SIDE LINING UP THE HOLES ON THE MACHINE TO THE SCREW HOLES ON THE PLATFORM. (REFER TO THE IMAGE ABOVE FOR REFERENCE). SECURE THE MACHINE TO THE PLATFORM USING THE SCREWS THAT DO NOT HAVE WASHERS.**

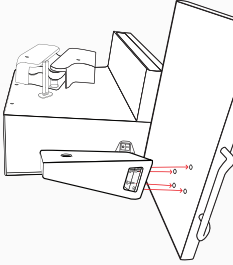

3. **PLACE PLATFORM UPRIGHT. LINE UP FILM HOLDER WITH THE 4 SCREW HOLES AND SCREW IN WITH INCLUDED WASHERS.**

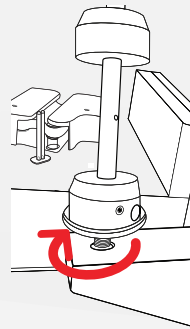

4. **SCREW FILM ROLLER INTO FILM HOLDER AND HAND TIGHTEN.**

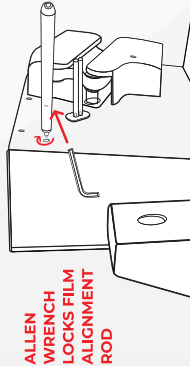

5. **INSERT THE FILM ALIGNMENT ROD (LOCATED IN THE FOAM PIECE) INTO THE MACHINE AND THEN INSERT ANY OF THE INCLUDED ALLEN WRENCHES INTO THE HOLE INDICATED ON THE IMAGE ABOVE. USE THE ALLEN WRENCH TO HELP TURN THE ROD CLOCKWISE AND SECURE THE ALIGNMENT ROD TO THE MACHINE. REMOVE ALLEN WRENCH ONCE SECURED.**

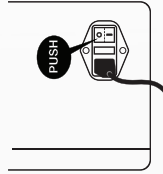

6. **PLUG IN THE POWER CABLE AND TURN THE MACHINE ON USING THE POWER SWITCH LOCATED ON THE BACK.**

2. Control Panel Operation

The name of each button in control panel is shown as following table:

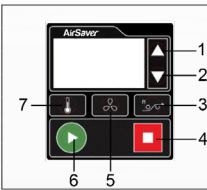
	No.	Name	Remark
	1	Increase Button	▲
	2	Decrease Button	▼
	3	Film Transfer Button	🎞️➡️
	4	Stop Button	🛑
	5	Air Volume Set Button	🔊
	6	Start Button	▶️
	7	Temperature Set Button	🌡️

2.2 Main Interface

After the machine is switched to on, the main interface will be displayed. The top of the screen will display the pillow size that is selected to run. Follow the operations guide to change pillow sizes. The middle of the screen will show what operating mode the machine is set to. The bottom left will display the heating status. The heating unit will always be set to 50%. The bottom middle will display operation status. The bottom right indicates if the transfer button is active.



3. Parameter Lock

Parameter locking prevents accidental changes to the heat and fan to avoid quality issues to the pillow that is being used. If parameters need to be adjusted, for example, adding more air to the air pillows, select the setting that requires changing, then press and hold the “Stop” for three seconds. To change the parameters, select the setting that requires changing then press and hold the **“Stop”** for three seconds. The machine will beep and unlock, use the **“Up”** and **“Down”** arrows to adjust. **Please note adjusting beyond recommended settings may cause quality and performance issues to the pillow.**

4. Operating Guide

AirSaver®

ASFX OPERATING GUIDE

Film Loading Instructions:

Step 1



1. Load film onto film roller with arrows facing towards the machine. Film will go under film align rod and in-between double rods.



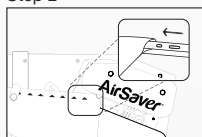



Step 2



2. On the side of the film that is closest to the machine, create a small opening and thread film through the feeding tube up to the belts.

3. On the machine press the  button and assist pulling the film to the front of the machine. This will ensure that the film is fed properly when the machine begins to produce pillows.







Start Generating Pillows:

- To select the pillow size, quickly press the  button then  button.
- The screen will display a list of pillow sizes. Select your corresponding pillow size by pressing the  button or  button then press the  button to select the pillow size.
- Press the  button to begin generating pillows.

Operating Modes:

Start/Stop Mode - Allows the user to continuously generate pillows until the  button is pressed. This will be the **default mode** when the machine is first turned on.

Timer Mode - Allows the user to set a timer on how long the machine will generate pillows.

To select **Timer Mode** quickly press the  then  arrow. The display will change and show Start/Stop and Timer below it. Select **Timer mode** by pressing the  button, while pressing adjust the time by using the  and  To finalize the selection hit the  button.

Sensor Mode - As an optional accessory the sensor can be attached to our basket. The sensor will sense when the basket is full and start the machine when the basket is not.

The machine will change over to **Sensor Mode** when the sensor is plugged in.

5. Troubleshooting

Issue	troubleshoot
Pillow Seal Leakage	If pillow is not holding air or when squeezed and the pillow puffs rather than pops.
	1.Squeeze pillow slow to see where leak is coming from. If leak is coming from the seal check the following.
	2.Confirm the Teflon belts are still on the heating unit. Confirm that belts are still intact and are in good condition. There should be no holes, rips or folds. There will be a top and bottom belt on the sealing unit.
	3.If belts are in working order then increase the heat in increments of 1 until sealing has improved. Note: Seal should look consistent and clean. Any stretching or separation is an indication of over sealing and will cause pillow integrity to be lower.
	4.If sealing does not improve Contact AirSaver Tech support at 1-800-782-9008.
Seal Separation	If the seal of the pillow is separating as it comes out then this is an indication that the sealing is too hot.
	To resolve this, decrease the heat in increments of 1 until sealing has stopped separating.
	Once separation has stopped check pillow to assure that there is no leaking with the decreased heat.
Film Fault Error	If the machine displays a "Film Fault" this indicates that there is no film running through the machine.
Film Jam	If a film jam occurs near the back the of the machine then likely the film was not loaded properly and the blade did not cut the film.
	To clear the Jam you will need to pull the Air Nozzle out. SAFETY NOTE: The cutting blade for the film is located on this assembly.
	1. Locate where the film is threaded onto the feeding tube (AirNozzle).
	2. With your index finger and thumb pull the feeding tube (Air nozzle) left.
	3. The Air Nozzle and blade assembly should come out. Remove the jammed-up film and reinstall the assembly.

6. Parts Replacement Method

6.1 Belt Replacement Instructions

Note: Machine should be turned off before touching the machine.

1. Remove the protective cover by unscrewing the two screws on the top cover and bottom cover.



2. On the right-side, lift the lever to open up the assembly.

Note: The next step will expose the blade.



3. Release the tension on the belt by using your left hand to decompress the left tension wheel. This will allow you to slide the belt off. Repeat the process on the bottom belt.

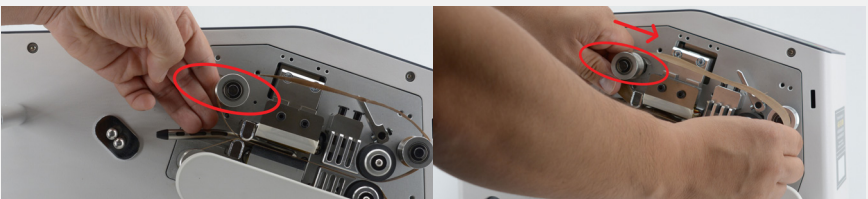

4. In reverse order, replace the belts by decompressing the left tension wheel and sliding on the belt on. Repeat the process for the bottom belt.



5. Close the heating sink and screw covers back in.



6.2 Blade Replacement Instructions

Note: Machine should be turned off before touching the machine.

1. Remove the protective cover by unscrewing the two screws on the top cover and bottom cover.



2. On the right-side, lift the lever to open up the assembly.

Note: The next step will expose the blade.



3. As shown in the picture below, pull the air nozzle to the left. The assembly will come out exposing the blade.



4. With the provided tool, carefully remove the nut holding the blade. Dispose of the blade appropriately and replace the new blade onto the nozzle and secure with the nut.

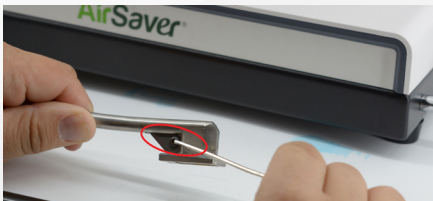

5. Install the nozzle and the covers back onto the machine and the machine will be ready to use.



6.3 Heating Block Replacement Instructions

1. Remove the protective cover by unscrewing the two screws on the top cover and bottom cover.



2. On the right-side, lift the lever to open up the assembly



3. Release the tension on the bottom belt by using your left hand to decompress the left tension wheel. This will allow you to slide the belt off.



4. With the provided tool, reference to the image below to locate the screws for the heating block. Unscrew the two screws under the heating block to remove it.



5. In reverse order, install the new heating block and secure it with the two screws.

